

Job: _____
 Engineer: _____
 Contractor: _____
 Prepared By: _____ Date: _____
 Model: _____ Indoor/Outdoor: _____

XFyre® - Type WH

Condensing Water Heaters
 Models 300A-850A

- Stainless Steel Water-tube Construction**
- 95% Thermal Efficiency at Full Rate**
- VERSA IC® Modulating Controller**
- LCD Status Display with Full Diagnostics and Fault Memory**
- Cascade up to Four Heaters – No External Sequencer Required**
- Modbus RTU BMS Port**
- Soft Start, Electronic Modulation, 5:1 Turndown**
- Maximum Outlet Water Temperature: 175°F**
- Maximum Setpoint: 150°F**
- 100% Factory Fire Tested**
- Zero Clearance to Combustibles**
- Indoor/Outdoor Construction Standard**
- PVC, CPVC, Centrotherm™ Polypropylene or Stainless Venting Certified¹**
- Meets 2012 NOx Requirements (< 20 ppm)**
- Limited Twenty-Five-Year Thermal Shock Warranty**
- Limited Ten-Year Heat Exchanger Warranty**



Proudly Assembled in the USA

Heat Exchanger

- All Stainless Steel Construction with Copper Connections
- Gasketless Heat Exchanger Design
- ASME H Stamped
160 PSIG Max Working Pressure
- National Board Approved
- ASME Pressure Relief Valve, Loose
 - 125 PSIG – Standard
 - ___ PSIG – Optional
- Temperature and Pressure Gauge, Shipped Loose

Control

- 120V, 60Hz, 1Ø, Power Supply
- VERSA IC Operating Control with LCD display
- 0-10 VDC input for BMS
- Cascade up to 4 water heaters
- Remote Flame Sensor
- High Limit, Manual Reset, Fixed, 175°F
- Alarm Dry Contact Connection
- On/Off Power Switch
- Flow Switch
- Blocked Vent Pressure Switch
- Boiler, DHW & System Pump Contacts
- Water Temperature Sensors (3)10kΩ (Tank sensor shipped loose)

Burner

- Spark Ignition (DSI)
- Ultra-Low NOx: Less than 20 PPM

Gas Train

- Fuel
 - Natural Gas
 - Propane
- Dual-Seat Combination Valve
- Electronic Modulating Firing Mode (WH7)

Construction

- Indoor/Outdoor Construction
- Front Controls Enclosed
- PolyTuf Powder Coat Finish
- Rear Connections (Electrical, Gas, Vent, Combustion Air)
- Top Connections (Water)
- Design Certified ANSI Z21.10.3/CSA 4.3
- Combustion Air Filter
- Condensate Trap
- CSA Low Lead Certified ≤ .25% Lead

Venting (PVC -CPVC- Centrotherm™ Polypropylene-Stainless)¹

- Vent Termination
 - D-15 Indoor, Horizontal – Option

- D-11 Outdoor Termination
- D-33 Polypropylene Adapter
- Extractor – Optional
 - By others
 - Not required

Options

- D-21 TruSeal® Combustion Air Inlet (Mounted)
- D-22 TruSeal® Combustion Air Inlet (Loose)
- F-10 Low Water Cut-Off, Remote Probe
- P-__ Pump: ___HP, 120V, 1Ø, 60Hz
 - Bronze/SS
- S-1/S-2 High/Low Gas Pressure Switches, Manual Reset
- Z-12 Condensate Neutralizer Kit

Regulatory Agency Requirements



Note 1: Configured for PVC Vent Standard. Maximum Return Water Temperature of 130°F on models WH7-700A and WH7-850A for PVC Vent. See I & O Manual Cat. 1000.65

Raypak
 A Rheem® Company

XFire – Type WH Models 300A-850A

Model _____

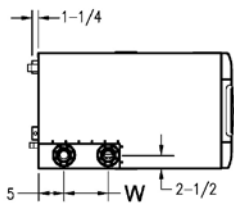

TOP VIEW

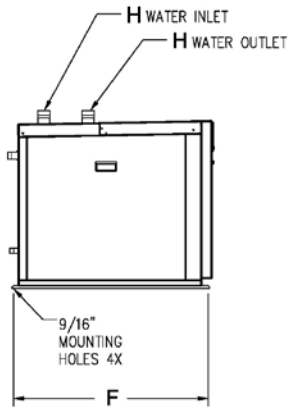

LEFT VIEW

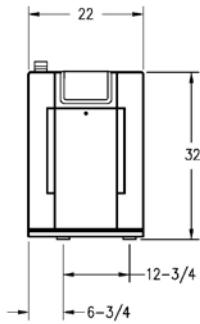

FRONT

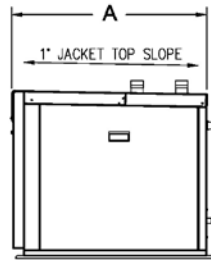

RIGHT VIEW

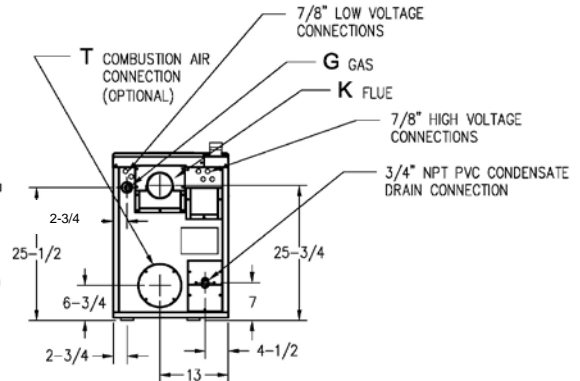

REAR

Model (H7-)	MBTUH		Dimensions (in.)						
	Input	Output	A Length	F Mounting	G NPT	H NPT	K Flue Ø	T C/A Ø	W (Water)
☐ 300A	300	282	28-1/4	27-9/16	3/4	1-1/2	4	4	8-1/2
☐ 400A	399	375	30-3/4	32-5/16	1	2	4	4	7
☐ 500A	500	470	37-1/4	36-9/16	1	2	4	4	8-1/2
☐ 700A	700	658	47-3/4	49-5/16	1-1/4	2	6	6	10-5/8
☐ 850A	850	799	54-1/4	53-9/16	1-1/4	2	6	6	10-5/8

	CLEARANCES (in.)	
	Certified Minimum	Service Clearance
Front	24	24
Rear	24	24
Right	0	0
Left	0	0
Top	12	24
Floor	0	-
Vent	1	-

Ratings shown are for elevations up to 2,000 feet. For installations at elevations above 2,000, please consult the factory for additional instructions.

Model (WH7-)	3-15 grains per gallon					Hard (16-25 grains per gallon)
	ΔT	GPM	ΔP	MTS	SHL	
☐ 300A	24	24	12	1.5	17	Do not use when hardness exceeds 15 grains per gallon
☐ 400A	20	38	18	2	20	
☐ 500A	20	48	16	2	19	
☐ 700A	20	67	30	2	36	
☐ 850A	23	70	30	2	36	

Model (H7-)	Amps*	Foot-Print (ft²)	Ship Weight (lbs.)
☐ 300A	3	4.3	410
☐ 400A	4	4.7	465
☐ 500A	4	5.7	505
☐ 700A	5	7.3	580
☐ 850A	5	8.3	580

* Current draw is for heater only.
(Supply breaker must have delayed trip.)

MTS = Minimum Tube Size, inch

SHL = System head loss, ft (based on heater and tank placed no more than 5ft apart & 75ft equivalent length of tubing and fittings).

ΔT = Temperature rise, °F

ΔP = Pressure drop through heat exchanger, ft

XFyre – Type WH

Models 300A-850A

Model _____

Model (WH7-)	Recovery Rates (gallons per hour)								
	Temperature Rise (°F)								
	20	30	40	50	60	70	80	90	100
<input type="checkbox"/> 300	1728	1151	863	691	576	494	432	384	345
<input type="checkbox"/> 400	2297	1532	1149	919	765	656	575	511	459
<input type="checkbox"/> 500	2879	1919	1440	1151	959	823	720	640	576
<input type="checkbox"/> 700	4031	2687	2015	1612	1344	1151	1008	986	806
<input type="checkbox"/> 850	4894	3262	2446	1958	1632	1398	1224	1087	978

Raypak, Inc. • Eastman Avenue, Oxnard, CA 93030 • (805) 278-5300 • (805) 872-9725 • www.raypak.com