

Job: \_\_\_\_\_  
Engineer: \_\_\_\_\_  
Contractor: \_\_\_\_\_  
Prepared By: \_\_\_\_\_ Date: \_\_\_\_\_

# Power Vent

For Raytherm®  
Models 514-1826

## Versatile

Suitable for use with hydronic heating boilers and hot water heaters

Permits sidewall venting

Allows use of smaller diameter vent pipe

## Efficient

Maintains thermal efficiency of 82% on all appliance sizes

## Multi-Position Capability

Fan discharge adjusts to match position of vent pipe, reducing number of fittings

## Draft Control

Barometric damper provides overfire draft when necessary



## Features

- Induced draft
- Barometric damper
- Plenum sized for appliance capacity
- Pre-wired and mounted, or shipped loose for field installation
- Air flow proving switch, mounted and wired
- Fan motor relay, mounted and wired
- Heavy-duty galvanized steel cabinet
- Polytuf powder coat finish
- Indoor construction
- Easy installation
- Limited one-year warranty

## Options

- Shipped loose for field mounting
- Shipped mounted on unit



**Raypak**  
A Rheem® Company

# Power Vent For Raytherm 514 - 1826

Model \_\_\_\_\_

## FIVE DIFFERENT DISCHARGE POSITIONS

ROTATE BLOWER ONLY

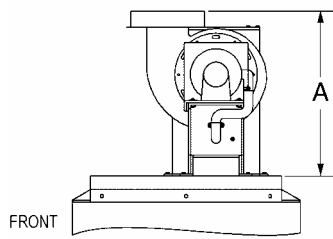

RIGHT SIDE

POSITION 1

STANDARD POSITION AS SHIPPED FROM FACTORY

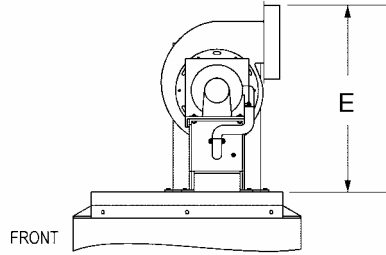

RIGHT SIDE

POSITION 2

ROTATE BLOWER HOUSING 90° CW FROM POSITION 1

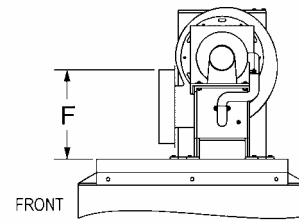

RIGHT SIDE

POSITION 3

ROTATE BLOWER HOUSING 90° CCW FROM POSITION 1

ROTATE PLENUM/BLOWER ASSEMBLY

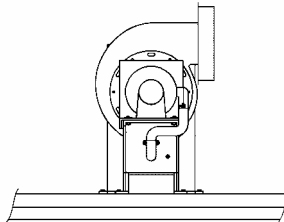

FRONT

POSITION 4

ROTATE PLENUM/BLOWER ASSY FROM POSITION 2 SO MOTOR IS TOWARD FRONT SIDE OF BOILER

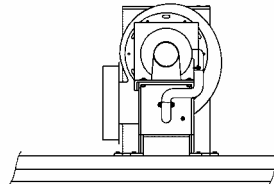

FRONT

POSITION 5

ROTATE PLENUM/BLOWER ASSY FROM POSITION 3 SO MOTOR IS TOWARD FRONT SIDE OF BOILER

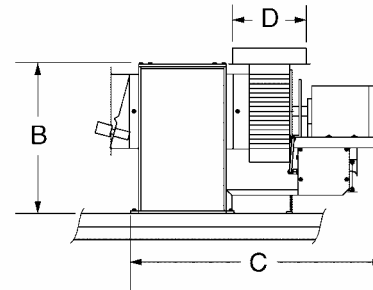

FRONT

Raytherm Model	MBTU	Max. Run (ft.)		Dimensions (in.)						Electrical Ratings at 120V			Max. CFM @ 70°F
		Vert.	Horiz.	A	B	C	D	E	F	W/out Pump	W/ Pump	HP	
514	512	20	40	17-7/8	15-7/8	20	8	20-1/4	9-3/4	< 10 Amps	< 16 Amps	1/3	925
624	627	20	22	17-7/8	15-7/8	20	8	20-1/4	9-3/4	< 10 Amps	< 16 Amps	1/3	925
724	726	20	13	17-7/8	15-7/8	20	8	20-1/4	9-3/4	< 10 Amps	< 16 Amps	1/3	925
824	825	20	22	17-7/8	15-7/8	20	8	20-1/4	9-3/4	< 10 Amps	< 16 Amps	1/3	925
962	962	20	12	17-7/8	15-7/8	20	8	21-13/16	11-5/16	< 10 Amps	< 16 Amps	1/3	925
1125	1125	20	5*	17-7/8	15-7/8	20	8*	21-13/16	11-5/16	< 10 Amps	< 16 Amps	1/3	925
1223	1223	20	4**	17-7/8	15-7/8	20	8**	21-13/16	11-5/16	< 10 Amps	< 16 Amps	1/3	925
1336	1336	20	21	21	18-5/8	42	10	23-1/2	12-1/2	< 18 Amps	< 24 Amps	1	1425
1468	1468	20	15	21	18-5/8	42	10	23-1/2	12-1/2	< 18 Amps	< 24 Amps	1	1425
1631	1631	20	10	21	18-5/8	42	10	23-1/2	12-1/2	< 18 Amps	< 24 Amps	1	1425
1826	1826	20	5*	21	18-5/8	42	10*	23-1/2	12-1/2	<18 Amps	< 24 Amps	1	1425

\* Maximum horizontal run can be increased to 70 ft. by using one size larger vent pipe. The larger pipe must be used starting at the power vent outlet. (Transition piece not supplied by Raypak.)

\*\* Maximum horizontal run can be increased to 32 ft. by using two sizes larger vent pipe. The larger pipe must be used starting at the power vent outlet. (Transition piece not supplied by Raypak.)

- NOTES:
- Vent pipe sizes are based on: standard vertical discharge, using one 90° elbow and one tee with a 90° turn; 300°F nominal flue temperature; and sea-level operation. For installation under other conditions, please consult the factory.
  - Flue pipe must meet Category III appliance venting requirements.
  - Follow installation instructions provided by power vent manufacturer.
  - Vent terminal should be installed with the motor on the right or front side of the boiler.
  - Overhang dimensions extend over front of appliance, but do not exceed service clearances.

Raypak, Inc. ▪ 2151 Eastman Avenue, Oxnard, CA 93030 ▪ (805) 278-5300 ▪ Fax (800) 872-9725 ▪ www.raypak.com