

Job: _____

Engineer: _____

Contractor: _____

Prepared By: _____ Date: _____

Model: _____ Indoor/Outdoor: _____ MBH Input: _____

Hi Delta SS™ - Type WH

Water Heaters
Models HD101-HD401

- TruSeal® Direct Vent**
- Sealed Combustion Chamber**
- 100% Factory Fire Tested**
- Efficiency: 85%**
- Maximum Outlet Temperature: 200°F**
- Minimum Non-condensing Inlet Temperature: 105°F**
- Thermal Shock Proof Heat Exchanger**
- Limited Twenty-year Thermal Shock Warranty**
- Limited Five-year Heat Exchanger Warranty**
- Status Display LED's**
- PolyTuf Powder Coated Cabinet**
- No Combustible Floor Shield Required**
- Fan-assisted – Ultra Low NOx (<20 ppm Nat.)**
- Patented Burner Security Blanket**

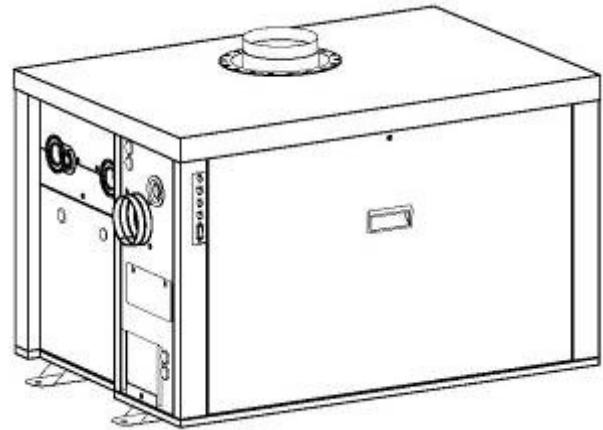

Patent No. 7,044,124



Proudly Assembled in the USA

Heat Exchanger

- HLW Stamp
- Headers
 - Bronze - Standard
 - Cast Iron, Glass-lined – Option A-2
- ASME Inspected and Stamped 160 PSIG Working Pressure
- National Board Approved
- Finned Tubing
 - Copper - Standard
 - Cupro Nickel – Option A-3
- ASME Steel Tube Sheet
- Silicone High Temp O-Rings
- ASME Pressure Relief Valve
 - 125 PSIG – Standard
 - 150 PSIG – Option A-16
- Temperature and Pressure Gauge (shipped loose)
- Flow Switch – Mounted
- Left-hand Water (Standard)
- Right-hand Water - Optional A-6

Controls

- 120V, 60Hz, 1Ø Power Supply
- 120/24V 60Hz Transformer
- 100% Shutoff/Lockout
- Hot Surface Ignition
- Remote Flame Sensor
- Fixed High Limit Control, Manual Reset
- On/Off Power Switch
- Blocked Vent Pressure Switch
- Combustion Air Proving Switches (2)
- Economaster Style Pump Relay

Gas Train

- 4" WC Minimum Pressure
- Combination Valve
- Firing Mode
 - On/Off (WH1) – Standard
 - 2 Stage (WH3) – Optional
- Fuel
 - Natural Gas
 - Propane Gas
- Design Certified - ANSI Z21.10.3/CSA 4.3

Burner

- Two-stage Capable
- Ultra-Low NOx (<20 ppm Nat.)

Construction

- Indoor/Outdoor Construction
- Slide-Out Controls Tray
- Front Controls Enclosed
- PolyTuf Powder Coat Finish
- TruSeal® Direct Vent
- Integral Combustion Air Filter
- CSA Low Lead Certified ≤ .25% Lead

Venting

- Vent Termination Cap
 - Outdoor – Option D-11
 - Indoor, Horizontal – Option D-15
 - Indoor, Vertical – Option D-20
- Combustion Air - Ducted
 - Air Intake Elbow – Option D-16
- Extractor – Optional
 - By Others
 - Not Required

Temperature Controls (Optional)

- B-2 1-Stage Controller, 100-200°F (Loose)
- B-3 2-Stage Controller, 100-200°F (Loose)
- B-26 TempTracker Digital Controller, 2-Stage (Mtd)
- B-21 TempTracker Digital Controller, 4-Stage (Loose)
- Remote Controller
- By others:

Options

- I-1 Adjustable High Limit Control, Auto Reset
- P-__ Pump: __ HP, 120V, 1Ø, 60 Hz Bronze only
 - Mounted
 - Loose
- P-__ Cold Water Protection (See 1000.19)
- S-__ Low and High Gas Pressure Switches, Manual



Raypak

A Rheem Company

Hi Delta SS HD101-HD401 Type WH - Domestic Hot Water

Model _____

Primary Pump HP - Amps			
Model (WH1)	Water Hardness		
	Soft	Medium	Hard
HD101	1/8 - 1.1	1/8 - 1.3	1/4 - 1.6
HD151	1/8 - 1.1	1/8 - 1.3	1/4 - 1.6
HD201	1/8 - 1.1	1/8 - 1.3	1/4 - 1.6
HD251	1/8 - 1.1	1/8 - 1.3	1/4 - 1.6
HD301	1/8 - 1.1	1/8 - 1.3	1/4 - 1.6
HD401	1/8 - 1.1	1/8 - 1.3	1/4 - 1.6

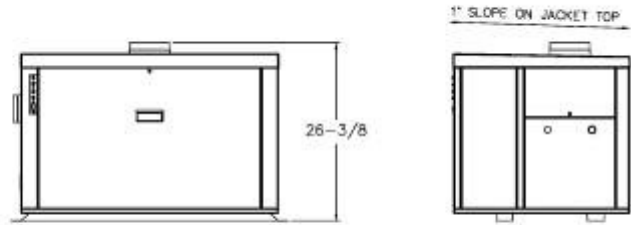
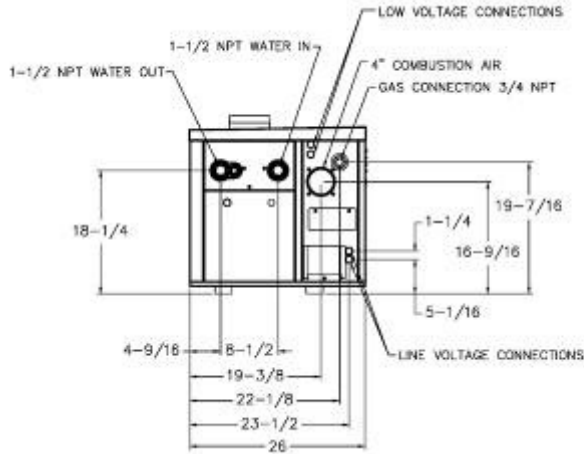
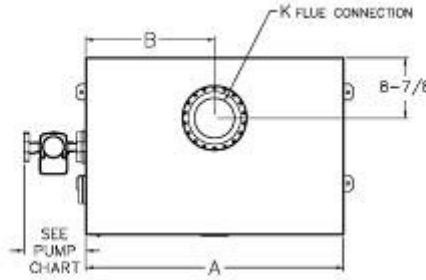

WATER HEATER RECOVERY RATES (GPH)

MODEL (WH1)	TEMPERATURE RISE IN °F								
	20°	30°	40°	50°	60°	70°	80°	90°	100°
HD101	510	340	255	204	170	146	128	113	102
HD151	765	510	383	306	255	219	191	170	153
HD201	1015	677	508	406	338	290	254	226	203
HD251	1276	850	638	510	425	364	319	283	255
HD301	1531	1020	765	612	510	437	383	340	306
HD401	2036	1357	1018	814	679	582	509	452	407

SPECIFICATIONS

Model	MBTUH		Firing Stages	A	B	K	Heater Amps	Approx. SHIP WT. (LBS)
	INPUT	Output						
HD101	100	85	1*	18-9/16	9-1/4	4	<5	150
HD151	150	128	1*	21-7/8	10-7/8	4	<5	175
HD201	199	169	1*	25-1/16	12-1/2	5	<5	200
HD251	250	213	1*	28-5/16	14-1/8	5	<5	225
HD301	299	254	1*	31-9/16	15-3/4	5	<5	250
HD401	399	339	1*	38-1/16	19	6	<5	300

* 2 Stage optional
Dimensions are in inches

RATES OF FLOW AND PRESSURE DROPS

Model	Input MBTUH	Output MBTUH	Soft (3-4 GPG)					Medium (5-15 GPG)					Hard (16-25 GPG**)				
			ΔT	GPM	ΔP	MTS	SHL	ΔT	GPM	ΔP	MTS	SHL	ΔT	GPM	ΔP	MTS	SHL
HD101	100	85	9	20	1.8	1-1/2	3.8	7	26	3.0	1-1/2	6.3	4	45	9.2	1-1/2	18.0
HD151	150	128	13	20	1.8	1-1/2	3.8	10	26	3.1	1-1/2	6.3	6	45	9.2	1-1/2	18.1
HD201	199	169	17	20	1.9	1-1/2	3.9	13	26	3.2	1-1/2	6.4	8	45	9.4	1-1/2	18.2
HD251	250	213	21	20	1.9	1-1/2	3.9	16	26	3.2	1-1/2	6.5	9	45	9.6	1-1/2	18.5
HD301	299	254	25	20	1.9	1-1/2	3.9	20	26	3.2	1-1/2	6.5	11	45	9.8	1-1/2	18.7
HD401	399	339	31	20	2.0	1-1/2	4.8	26	26	3.3	1-1/2	6.6	15	45	10.3	1-1/2	19.1

NOTE: Basis for minimum flow is 13 GPM or 40°F ΔT.
GPG = Grains Per Gallon

** If over 25 GPG, must use a water softener
SHL includes 50 ft of tubing each way (total 100ft)

- NOTES: 1. Rates shown are for natural or propane gas, and elevations up to 2,000 feet. For installations above 2,000 feet, please contact manufacturer.
2. Recommended natural gas pressure is 7 - 10.5" WC. Recommended propane gas pressure is 11 - 13" WC.