



SUBMITTAL COVER SHEET

PROJECT NAME _____

LOCATION _____

ARCHITECT _____

ENGINEER _____

CONTRACTOR _____

SUBMITTED BY _____ DATE _____

UNIT SUMMARY

Quantity						
Unit Designation						
Model No.						
Total Cooling						
Sensible Cooling						
Air Ent. Evaporator						
Air Lvg. Evaporator						
Heating Input						
Heating Output						
CFM/ESP						
EER/SEER						
Electrical						
Minimum Ampacity						
Min.-Max. Breaker						
Net Unit Weight						
Accessory						
Catalog Form Number						

ACCESSORIES:

NOTES:

SUBMITTAL SHEET FOR RQNJ- PACKAGE HEAT PUMP UNITS

2 Thru 5 Nominal Tons [7 thru 17.6 kW]

JOB NAME _____ DATE _____

CONTRACTOR _____ UNIT DESIGNATION _____

ENGINEER _____ MODEL NO. _____

SUBMITTED FOR ☐ APPROVAL ☐ RECORD LOCATION _____

SUBMITTED BY _____ ORDER NO. _____

UNIT DATA

COOLING PERFORMANCE

TOTAL CAPACITY* MBH
SENSIBLE CAPACITY* MBH
OUTDOOR DESIGN TEMP. °F [°C] DB/WB
TOTAL SUPPLY AIR CFM [L/s]
TEMP. OF AIR ENTERING
EVAPORATOR COIL..... °F [°C] DB/WB
POWER INPUT REQUIREMENT KW
SEER RATING.....
(*uses blower motor heat)

HEATING PERFORMANCE

GAS HEAT INPUT CAPACITY..... MBH
HEAT PUMP HEATING PERFORMANCE
CAPACITY @ 47°F MBH
CAPACITY @ 17°F MBH
COEFFICIENT OF PERFORMANCE
@ 47°F..... C.O.P.
@ 17°F..... C.O.P.
ELECTRIC HEAT CAPACITY KW
H.S.P.F.

SUPPLY AIR BLOWER PERFORMANCE

TOTAL SUPPLY AIR CFM [L/s]
TOTAL RESISTANCE EXTERNAL
TO UNIT IWG
BLOWER SPEED RPM
POWER OUTPUT REQUIREMENT .. BHP
MOTOR RATING HP [W]
POWER INPUT REQUIREMENT KW

ELECTRICAL DATA

POWER SUPPLY / /
TOTAL UNIT AMPACITY..... AMPS
MINIMUM WIRE SIZE AWG
MAXIMUM OVERCURRENT DEVICE
FUSES HACR BREAKER AMPS

TOTAL UNIT WEIGHT

TOTAL OPERATING WEIGHT LBS [kg]
(including field-installed accessories)

CLEARANCES

SIDE "A"	18" [457 mm]
SIDE "B"	0"
SIDE "C"	12" [305 mm]
SIDE "D"	30" [762 mm]
ABOVE UNIT	60" [1524 mm]

FEATURES FOR RQNJ-

- Scroll Compressor
- Copper Tube/Aluminum Fin Coils
- Powder painted louvered steel cabinet protects coil from damage
- Painted Base Pan
- Demand Defrost Control
- Non-Cycling Reversing Valve
- Gauge Ports
- Control box is fully accessible
- Power and control wiring are kept separate
- Certified and rated under ARI Standard 240
- U.L. listed
- Factory run tested prior to shipment
- Factory limited warranty on parts as follows:
Condenser Coil leaks caused byFive (5) Years
CompressorFive (5) Years
Any Other PartsFive (5) Years
Single-Phase Residential ApplicationsFive (5) Years
Commercial Applications.....One (1) Year

[] Designates Metric Conversions



DIMENSIONS

Model	Height "A"
024, 030, 036	29 1/8"
042, 048, 060	37 1/8"

FRONT VIEW

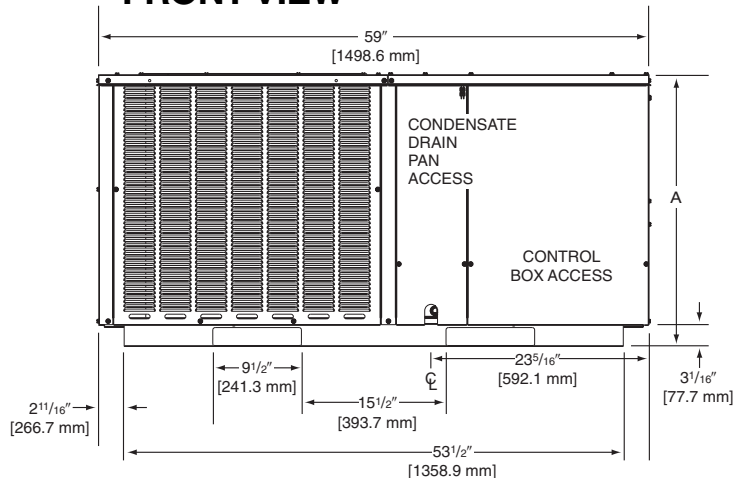

REAR VIEW

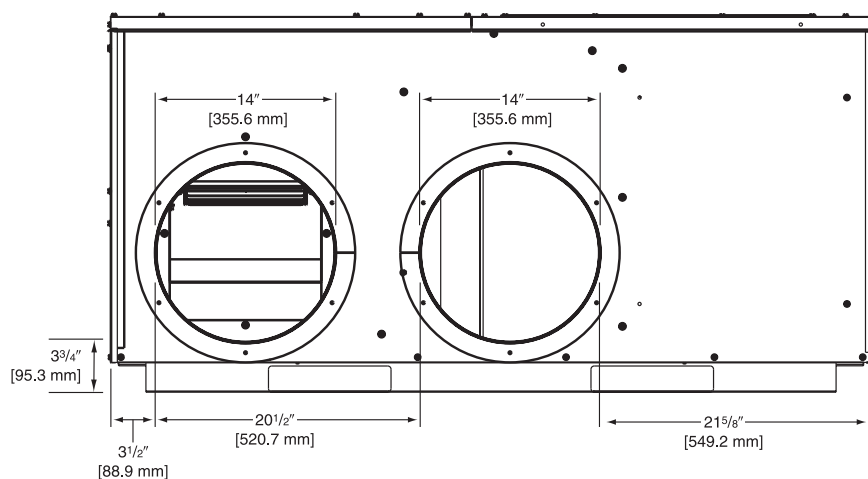

ELECTRICAL CONNECTIONS

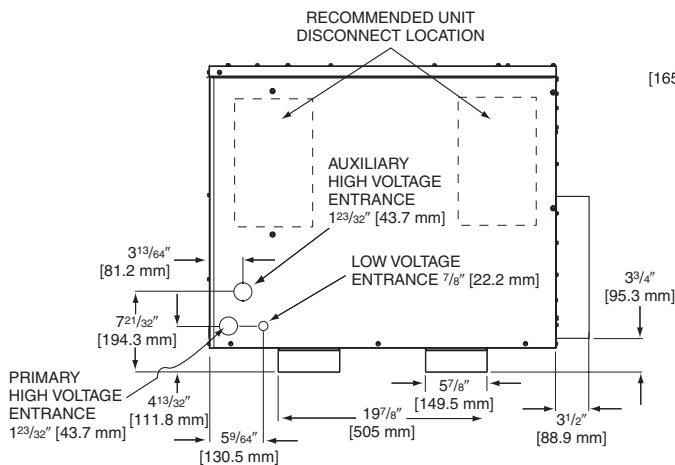

BOTTOM VIEW

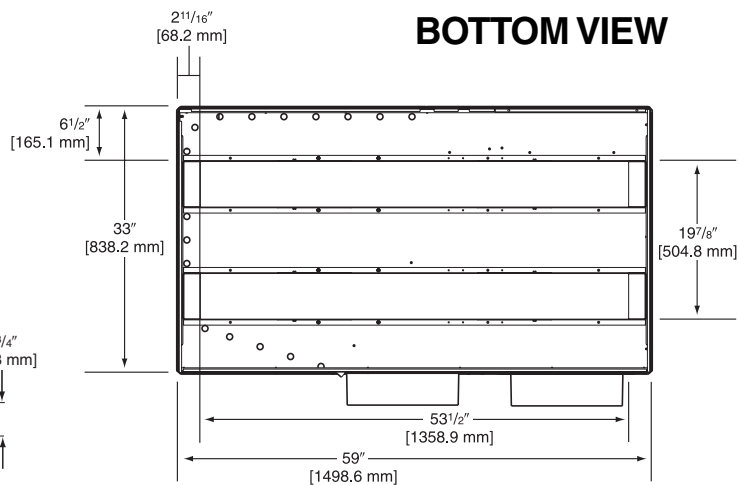

[] Designates Metric Conversions

Before proceeding with installation, refer to installation instructions packaged with each model, as well as complying with all Federal, State, Provincial, and Local codes, regulations, and practices.

RHEEM
MANUFACTURING
COMPANY
5600 Old Greenwood Road, Fort Smith, Arkansas 72908

"In keeping with its policy of continuous progress and product improvement, Rheem reserves the right to make changes without notice."

PRINTED IN U.S.A.

10-07 DC

FORM NO. X33-1197 REV. 3
Supersedes Form No. X33-1197 Rev. 2