

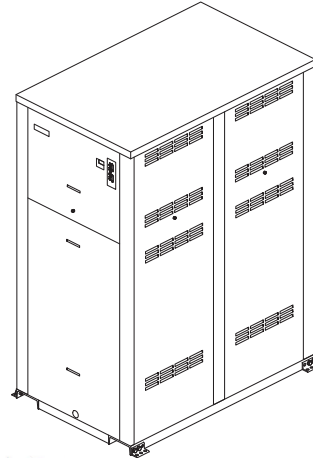

Job: _____
 Engineer: _____
 Contractor: _____
 Prepared By: _____ Date: _____
 Model: _____ Indoor/Outdoor: _____

XTherm™ - Type WH

Water Heaters
 Models 1005-2005

- 97% Thermal Efficiency at Full Rate; Up to 99% at Part Load
- 100% Factory Fire Tested
- Maximum Outlet Water Temperature: 190°F
- Minimum Acceptable Inlet Water Temperature: 50°F
- Full Safety Diagnostics with History
- Footprint: Less Than 10.8 ft²
- Limited Twenty-Five-Year Thermal Shock Warranty
- Limited Five-Year Copper/Ten-Year Cupro-Nickel Primary Heat Exch. Warranty
- Limited Five-Year Condensing Heat Exchanger Warranty
- Full Electronic Modulation, Constant Ratio 4:1 Turndown
- Modulating Controller with LCD Display
- Status Display Lights



 Proudly Made in the USA

Heat Exchanger

- Bronze Headers
- ASME HLW Stamped; 160 PSIG MAWP
- National Board Listed
- Fin Tubing
 - Copper – Standard
 - Cupro Nickel – Option A-3
- ASME Powder-Coated Tube Sheet
- Silicone High Temp O-Rings
- ASME Pressure Relief Valve
 - 125 PSIG – Standard
 - 150 PSIG – Option A-16
- 150 PSI Air Vent, Auto
- T&P Gauge, Shipped Loose
- Stainless Steel Condensing Heat Exchanger
- Stainless Steel Evaporator Plate
- Boiler Pump: Bronze, 120V, 1Ø, 60Hz
 Water Hardness: _____ GPG

Control

- 120V, 60Hz, 1Ø, Power Supply
- 120/24V 60Hz Transformer
- Ignition Module
 - 3-Try – Standard
 - Single-Try – Option C-6
- Hot Surface Ignition (HSI)
- Remote Flame Sensor
- Fixed High Limit, Manual Reset, 200°F
- On/Off Power Switch
- Flow Switch
- Blocked Vent Pressure Switch
- Combustion Air Proving Switch
- Freeze Protection
- Pump Switch
- Pump Time Delay
- Alarm Dry Contact

Control (cont.)

- Diagnostics Panel with LCD Display, 2 lines, 20 characters
- Modulating Temperature Control
- Water Temperature Sensors (3)
- Cold Water Protection
- Blocked Condensate Switch

Burner

- Ultra-Low NOx: Less than 20 PPM (Natural Gas Only)

Gas Train

- Fuel
 - Natural Gas
 - Propane
- Zero Governor Regulator
- Dual-Seat Combination Valve
- Electronic Modulating Firing Mode (WH7)

Construction

- Indoor/Outdoor Construction
- Front Controls Enclosed
- PolyTuf Powder Coat Finish
- Rear Connections (Water, Gas, Vent, Electrical, Comb. Air, Cond. Drain)
- Combustion Air Filter
- Design Certified ANSI Z21.10.3/CSA 4.3
- CSA Low Lead Certified ≤ .25 Lead
- Front Connection Low-Voltage Wiring

Venting

- Vent Termination, Cat IV
 - Outdoor or Indoor, Vertical – Option D-11
 - Indoor, Horizontal – Option D-15
- Extractor – Optional, Cat II
 - By others
 - Not required

Multi-Heater Digital Temp Controllers

- B-36 TempTracker Mod+ Hybrid, 2-4 Heaters
- B-37 TempTracker Mod+ Hybrid, 5-10 Heaters
- B-38 TempTracker Mod+ Hybrid, 11-16 Heaters
- B-45 Multi-Mod Platinum, 2-4 Heaters
- B-46 Multi-Mod Platinum EMS, 2-4 Heaters
- B-47 Multi-Mod Platinum BACNet, 2-4 Heaters
- B-48 Multi-Mod Expansion Module, 1-8 Additional Heaters

Options

- D-32 PVC Vent Adapter, Factory-mtd ONLY
- D-33 Polypro Vent Adapter, Factory-mtd or Field-mtd
- I-3 High Limit, Auto Reset, Adj., 40-180°F
- I-5 High Limit, Manual Reset, Adj., 100-200°F
- S-1 Low Gas Pressure Switch, Manual Reset
- S-2 High Gas Pressure Switch, Manual Reset
- Z-12 Condensate Neutralizer Kit

Regulatory Agency Requirements



Raypak®
 A Rheem® Company

XTherm – Type WH

Models 1005-2005

Model _____

NOTE: Primary/Secondary plumbing is mandatory for proper operation.

CLEARANCES (in.)

	Front	Rear	Right	Left	Top	Floor	Vent
Certified Minimum	24	12	1	1	0	0	1
Minimum Service	24	36	24	1	10	N/A	N/A

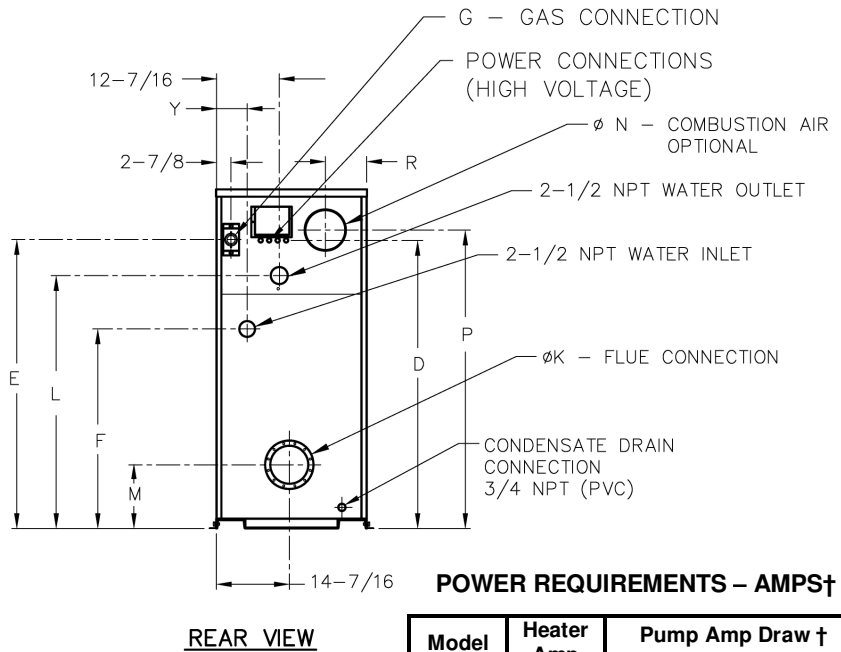
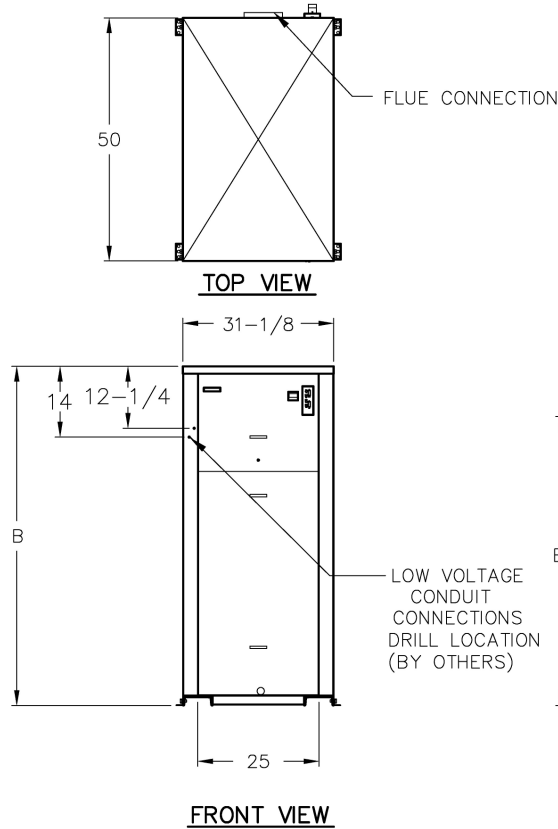

POWER REQUIREMENTS – AMPS†

Model (WH7-)	Heater Amp Draw †	Pump Amp Draw †		
		Soft	Medium	Hard
1005	12**	10	10	14
1505	12**	10	14	17
2005	18**	17	17	N/A

† Separate power connections are factory supplied and separate supply breakers must be field supplied.
 ** Current draw is for heater only (Supply breaker must have delayed trip).

Model (WH7-)	MBTUH		Dimensions (in)											Ship Weight (Lbs.)	
	Input	Output	B Height	D	E	F	G* NPT	K Flue Ø	L	M	N C/A Ø	P	R		Y
1005	999	969	55-1/8	45	47-1/8	36-1/2	1-1/4	6	40-1/16	11-1/2	6	47-1/8	8-1/16	6-1/16	1065
1505	1500	1455	67-1/8	57	59-1/16	38-1/2	1-1/4	8	52-1/16	12-5/8	8	59-1/8	8-3/16	6-1/16	1234
2005	1999	1939	81-1/8	71	71-3/16	38-1/2	2	8	64-1/16	12-5/8	8	73-1/8	8-3/16	6-1/4	1461

Note: Ratings shown are for elevations up to 4,500 feet. For installations at elevations above 4,500 feet, please consult the factory for additional instructions.

* For Propane Gas, all models are 1" NPT

Model (WH7-)	RECOVERY RATES									
	Temperature Rise (°F)									
	20	30	40	50	60	70	80	90	100	
1005	5817	3878	2908	2327	1939	1662	1454	1293	1163	
1505	8733	5822	4367	3493	2911	2495	2183	1941	1747	
2005	11639	7759	5813	4656	3880	3325	2910	2586	2328	