



# SUBMITTAL COVER SHEET

PROJECT NAME \_\_\_\_\_  
 LOCATION \_\_\_\_\_  
 ARCHITECT \_\_\_\_\_  
 ENGINEER \_\_\_\_\_  
 CONTRACTOR \_\_\_\_\_  
 SUBMITTED BY \_\_\_\_\_ DATE \_\_\_\_\_

## UNIT SUMMARY

Quantity						
Unit Designation						
Model No.						
Total Cooling						
Sensible Cooling						
Air Ent. Evaporator						
Air Lvg. Evaporator						
Heating Input						
Heating Output						
CFM/ESP						
EER/SEER						
Electrical						
Minimum Ampacity						
Min.-Max. Breaker						
Net Unit Weight						
Accessory						
Catalog Form Number						

**ACCESSORIES:**

**NOTES:**

# SUBMITTAL SHEET FOR PACKAGE HEAT PUMP: EQUIPPED WITH ClearControl™

RJNL-C WITH CAPACITIES OF 3-6 TONS [10.6-21.1 kW]  
RJPL-C WITH CAPACITIES OF 3-5 TONS [10.6-17.6 kW]

**R-410A**

JOB NAME \_\_\_\_\_  
 CONTRACTOR \_\_\_\_\_  
 ENGINEER \_\_\_\_\_  
 LOCATION \_\_\_\_\_  
 ORDER NO. \_\_\_\_\_  
 SUBMITTED FOR  APPROVAL  RECORD  
 SUBMITTED BY \_\_\_\_\_  
 DATE \_\_\_\_\_  
 UNIT DESIGNATION \_\_\_\_\_  
 MODEL NO. \_\_\_\_\_

## UNIT DATA

### COOLING PERFORMANCE

TOTAL CAPACITY*	_____	MBH
SENSIBLE CAPACITY*	_____	MBH
EFFICIENCY (at AHRI)	_____	EER
AMBIENT DB TEMP	_____	°F
ENTERING DB TEMP	_____	°F
ENTERING WB TEMP	_____	°F
LEAVING DB TEMP	_____	°F
LEAVING WB TEMP	_____	°F
TOTAL POWER INPUT	_____	kW
ELEVATION	_____	FT
SOUND POWER	_____	DBELS

### HEATING PERFORMANCE

HEAT PUMP HEATING PERFORMANCE		
CAPACITY @ 47°F	_____	MBH
CAPACITY @ 17°F	_____	MBH
COEFFICIENT OF PERFORMANCE		
@ 47°F	_____	C.O.P.
@ 17°F	_____	C.O.P.
ELECTRIC HEAT CAPACITY	_____	kW

### SUPPLY AIR BLOWER PERFORMANCE

SUPPLY AIR	_____	CFM [L/s]
OUTSIDE AIR	_____	CFM [L/s]
EXTERNAL STATIC PRESSURE	_____	IWG
DUCT CONNECTION LOCATION		
BLOWER SPEED	_____	RPM
MOTOR RATING	_____	HP [W]
BRAKE HORSEPOWER	_____	BHP
POWER INPUT REQUIREMENT	_____	kW

### ELECTRICAL DATA

POWER SUPPLY	_____	Hz
MINIMUM CIRCUIT AMPACITY	_____	AMPS
MAXIMUM OVERCURRENT DEVICE		
FUSE SIZE	_____	AMPS
HACR CIRCUIT BREAKER	_____	AMPS

### DIMENSIONS & WEIGHT

HEIGHT	_____	IN	WIDTH	_____	IN	DEPTH	_____	IN
TOTAL WEIGHT		_____	LBS		[kg]	(including factory options)		

### CLEARANCES

FRONT	48" [1219 mm]
CONDENSER COIL	18" [457 mm]
DUCT SIDE	18" [457 mm]
EVAPORATOR END	18" [457 mm]
ABOVE UNIT	60" [1524 mm]

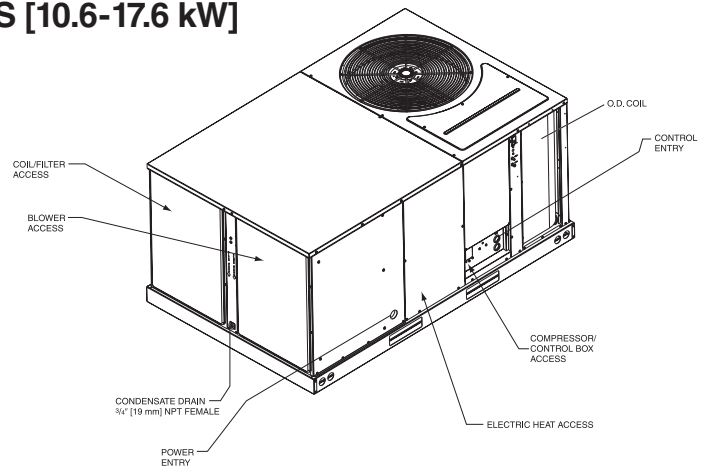

### 3-5 TON MODELS

#### BACK VIEW

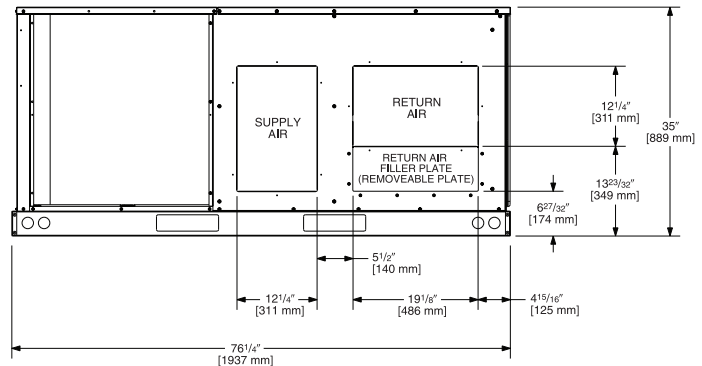

#### FRONT VIEW

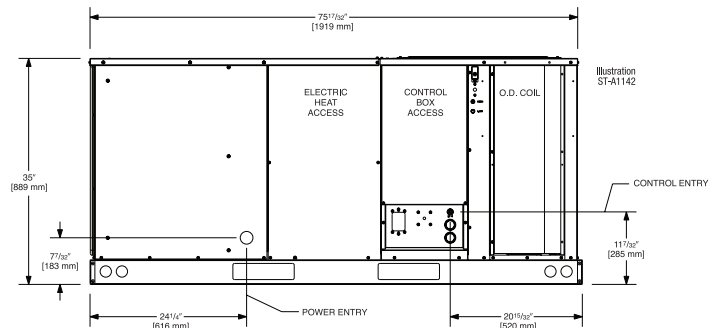

#### SIDE VIEW

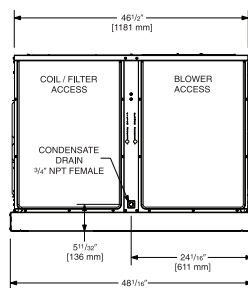

#### BOTTOM VIEW

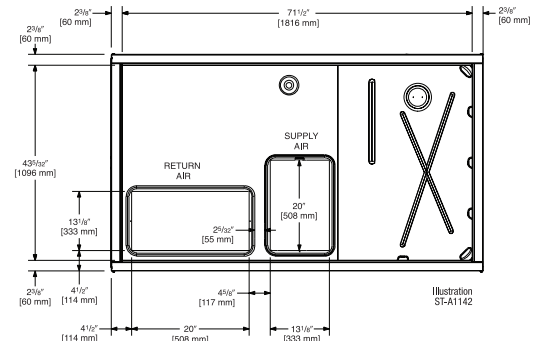

[ ] Designates Metric Conversions

**6 TON MODELS**

**BACK VIEW**

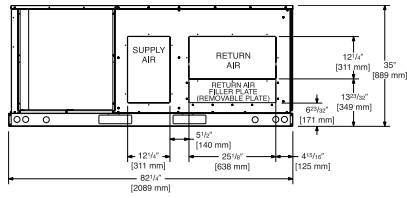

**BOTTOM VIEW**

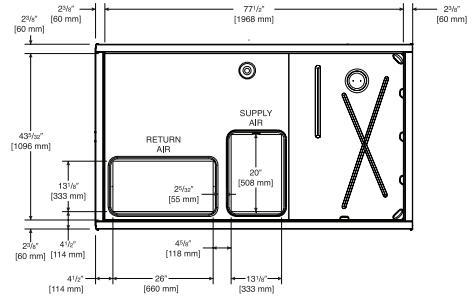

**SIDE VIEW**

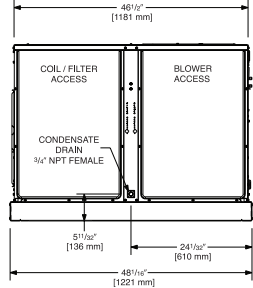

**FRONT VIEW**

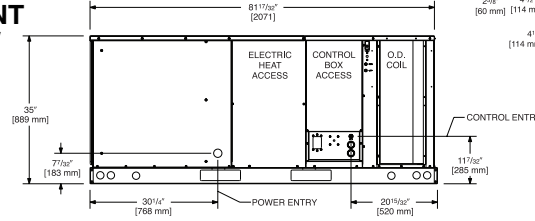

**FEATURES FOR PACKAGE HEAT PUMP UNITS  
RJNL-C 3-6 TONS [10.6-21.1 kW]/RJPL-C 3-5 TONS [10.6-17.6 kW]**

- R-410A HFC refrigerant.
- Complete factory charged, wired and run tested.
- Scroll compressors with internal line break overload and high-pressure protection.
- Single stage compressor on all models.
- Convertible airflow.
- TXV refrigerant metering system on each circuit.
- High Pressure protection standard on all models. Low Pressure/Loss of charge protection standard on all models.
- Solid Core liquid line filter drier on each circuit.
- Single slab, single pass designed evaporator coil facilitate easy cleaning for maintained high efficiencies.
- Cooling operation up to 125 degree F ambient.
- Easy access to filter, blower, electric heat, and compressor/control compartments permit prompt service.
- Powder Paint Finish meets ASTM B117 steel coated on each side for maximum protection. G90 galvanized.
- One piece top cover and one piece base pan with drawn supply and return opening for superior water management.
- Externally mounted refrigerant gauge ports for easy service diagnostics.
- Easy to install plug-in; slip in, 100% fully modulating economizer with barometric relief.
- Forkable base rails for easy handling and lifting.
- Single point electrical connection.
- High performance belt drive motor with variable pitch pulleys and quick adjust belt system.
- Permanently lubricated evaporator and condenser motors.
- Condenser motors are internally protected, totally enclosed with shaft down design.
- 1 inch filter standard with slide out design.
- Colored and labeled wiring.
- Copper tube/Aluminum Fin coils.
- Molded compressor plug.
- Supplemental electric heat provides 100% efficient heating.
- Factory installed ClearControl™, a Direct Digital Control (DDC) and sensors which can connect to LonWorks™ or BACnet® BAS systems for remote monitoring and control.

**ACCESSORIES**

**Factory Installed**

- Oversized Blower motor .....
- Outdoor Coil Guard .....
- Non-Powered Convenience Outlet.....
- Low Ambient w/Comfort Alert® Control .....
- Single Enthalpy Economizer w/Barometric Relief and DDC .....
- Single Enthalpy Economizer w/Barometric Relief, Smoke Detector and DDC .....
- Electric Heater Kits.....
- Comfort Alert® Control .....

**Field Installed**

- Outdoor Coil Guard .....
- Non-Powered Convenience Outlet.....
- Low Ambient Control .....

- 14" Full Perimeter Roofcurb .....
- 24" Full Perimeter Roofcurb .....
- Roofcurb Adapter.....
- Concentric Diffuser.....
- Manual Outside Air Intake Damper.....
- Motorized Outside Air Intake Damper.....
- Motorized Outside Air Intake Damper w/DDC Feedback .....
- Dual Enthalpy Adapter .....
- Power Exhaust .....
- CO<sub>2</sub> Sensor (wall mount with LCD) .....
- Thermostats .....
- BACnet® Communication Card .....
- LonWorks™ Communication Card .....

[ ] Designates Metric Conversions

**Before proceeding with installation, refer to installation instructions packaged with each model, as well as complying with all Federal, State, Provincial, and Local codes, regulations, and practices.**

Rheem Sales Company, Inc.  
P.O. Box 17010, Fort Smith, AR 72917

*"In keeping with its policy of continuous progress and product improvement, Rheem reserves the right to make changes without notice."*