



The new degree of comfort.™

# Worry-Free From Every Angle. RHEEM 80% GAS FURNACES



We Thought of Everything... And Then Some.

**You told us our existing 80% Gas Furnace line was the best\* in its class – but that didn't stop us from making it better and even more reliable. We've included 20-plus new features\*\* for a completely redesigned, trouble-free furnace that installs easier than ever – and it looks good, too!**



## 360° Performance™

The new 80% Gas Furnace line delivers a quieter, more reliable performance that will impress your most selective customers. Strategically designed hemmed edges\*\* improve the door seal, assuring less than 2% air leakage\*\* and less noise. Rubber vibration isolators\*\* on the motor mounts and a twist lock wire harness in the blower shelf\*\* also lend to quieter furnaces. The new line comes with more system match-ups, which means more options to meet homeowners' needs, and fewer SKUs to carry. And for a complete 360° performance, we included a smart feature that promises greater reliability than ever before.



### PlusOne™ Ignition System

Extensive research and development went into optimizing the technology for our proven Direct Spark **Ignition System**. The result is an ignition system that is nine times more reliable than most hot surface igniters. This Rheem-exclusive feature is the same ignition system used on commercial HVAC equipment and in gas home appliances. Your customers will enjoy unmatched durability for years of worry-free operation.



## 360° Installability™

When dealers talk about what they're looking for in an installation, we pay close attention. That's why the new 80% Gas Furnace line was designed with unique features that will make your job quicker and easier. Our 34" cabinet fits easily in closets, alcoves, crawl spaces and other tight areas for expanded installation flexibility. The hemmed edges\*\* of our new furnace line provide more structural integrity when installed in a horizontal position. And because each unit is backward compatible, there's no need to change the vent pipe location. To make the job even simpler, our control boards have dip switches. Set-up is easy and you won't waste valuable time looking for lost jumpers!



## 360° Serviceability™

Service calls are a breeze with the 80% Gas Furnace line. You're going to love the quarter-turn doorknobs\*\* that get you inside the furnaces quickly – with no tools required. And once inside, a QR code speeds up the diagnostics process even more, since you can use your smartphone or tablet to access the installation and operations manual, on the spot. The furnace blower is mounted on a rail system\*\*, and the blower shelf can be pulled out for service by removing only two fasteners. Now, that's easy! The blower capacitor and transformer have also been relocated for quick and easy access\*\*. To simplify motor replacement, we reduced the number of motor types used in the new line. And our service-friendly heat exchanger design allows for quick and easy cleaning, since clean furnaces are long-running furnaces. We even included a PlusOne feature for unmatched serviceability.



### PlusOne™ Diagnostics

A dual combination of 7-segment LED and EcoNet™-enabled diagnostics makes this PlusOne feature a service technician's dream. Our 7-segment alphanumeric LED display takes the guesswork out of service calls. In addition, our R802V models go a step further and feature a dual 7-segment LED display. You can diagnose a problem more accurately for faster service calls and fewer callbacks. We're the first in the industry to include this easy-to-read display on all product families.

To get instant access to the fault history, use a dip switch on the control board (or push button on our R802V models). For even more serviceability, our R802V models are enabled with EcoNet diagnostics for fast and accurate system information.



## 360° Integration™

### EcoNet™

EcoNet is an exclusive technology that allows Rheem heating, cooling and water heating products to communicate with each other on one integrated network. In addition to giving homeowners an easy way to control the most energy-consuming systems in the home – from home or on-the-go – it also makes it faster and easier for you to accurately install, set up and maintain a complete home comfort system.



\*80% Gas Furnace and AC Focus Group Analysis/February 10, 2011

\*\*Upflow/Horizontal models only



## What is 360°+1?

For nearly a century, Rheem has been the industry leader, pioneering numerous industry firsts that meet the needs of homeowners and dealers. We consider the work that goes into installing and servicing our products as well as how we can deliver the best homeowner experience... and then we take it further. That's 360°+1.

We engineered performance, innovation and everyday improvements into even the smallest details, resulting in four key product feature categories:

✓ 360° Performance™

⌚ 360° Installability™

⚙️ 360° Serviceability™

🔌 360° Integration™

We took it a step further and delivered “PlusOne™” advantages – unique Rheem innovations designed to make your job easier while providing homeowners with the ultimate home comfort experience.



**Classic® Series**  
R801S / R801P



**Prestige™ Series**  
R802V



**Classic Plus™ Series**  
R801T / R802P

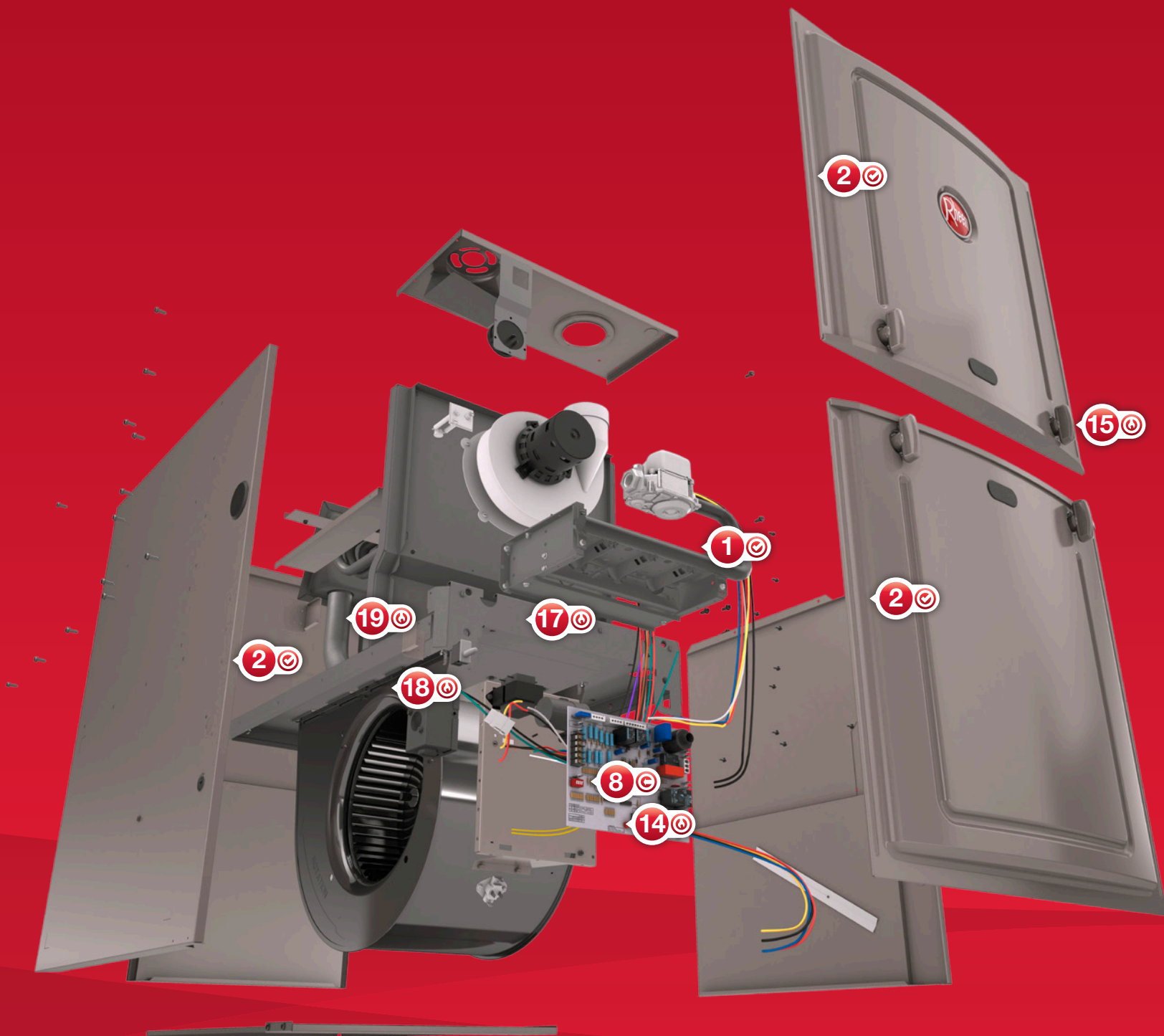



## 360° Performance™

- 1 PlusOne™ **Ignition System** – nine times more reliable than most hot furnace igniters
  - 2 Hemmed edges\* – improve door seal for less noise and less than 2% air leakage
  - 3 Rubber vibration isolators on motor mounts\* – reduce noise
  - 4 Modern aesthetics – add visual appeal
  - 5 EcoNet™-enabled\*\* – optimizes system performance
  - 6 More system match-ups available – allow for more efficiency options
- 



## 360° Installability™

- 7 34" high cabinet – allows for installation in space-constrained areas
  - 8 Dip switches on control boards – make set up easier than jumpers
  - 9 4" flue connections accessory option on all models – speed up installation when replacing existing 80% furnace (can fit 3" flue pipe if needed)
  - 10 Hemmed edges\* – easier handling
  - 11 Four-wire installation for EcoNet\*\* enabled systems – for faster, hassle-free installation
  - 12 EcoNet auto-configured\*\* – automatically configures system to proper airflow and setting
  - 13 Backward-compatible venting – for more retrofit installations
- 



## 360° Serviceability™

- 14 PlusOne™ **Diagnostics** – 7-segment LED on all units
- 15 Quarter-turn doorknobs\* – no tools required
- 16 Non-volatile fault-code history – allows for faster, more accurate diagnostics
- 17 QR code – easier access to installation and operations manual using a smartphone or tablet
- 18 Blower shelf rail system\* – provides easy access for service
- 19 Heat exchanger design – makes cleaning easy
- 20 EcoNet diagnostics\*\* – for more accurate diagnostics and serviceability
- 21 ¼" fasteners – fewer tools needed
- 22 Less replacement motors – fewer options make service simple and quick
- 23 Relocated blower capacitor and transformer – front access improves serviceability
- 24 Hemmed edges\* – easier handling allows for faster service

*\*Upflow/Horizontal models only*

*\*\*EcoNet available only on R802V models*



The new degree of comfort.™



The new degree of comfort.™

## Why Rheem?

### Relationship, Dedication and Innovation

Rheem makes customers our first priority. Our approach as a company is to keep the dialogue ongoing and to listen. Then act. The innovations we've developed throughout the years in both the HVAC and water heating industries are a direct result of that process. And we have a long list of industry firsts to show for it, with more to come. Rheem is dedicated to providing the products your customers need and the opportunities you want to expand your offerings and increase profitability. That's the Rheem 360°+1 approach to partnership.



Learn more at [MyRheem.com/360](http://MyRheem.com/360).

We Thought of Everything... And Then Some.